

Operating Instruction

*ICE BOX CHILLER **MINI***

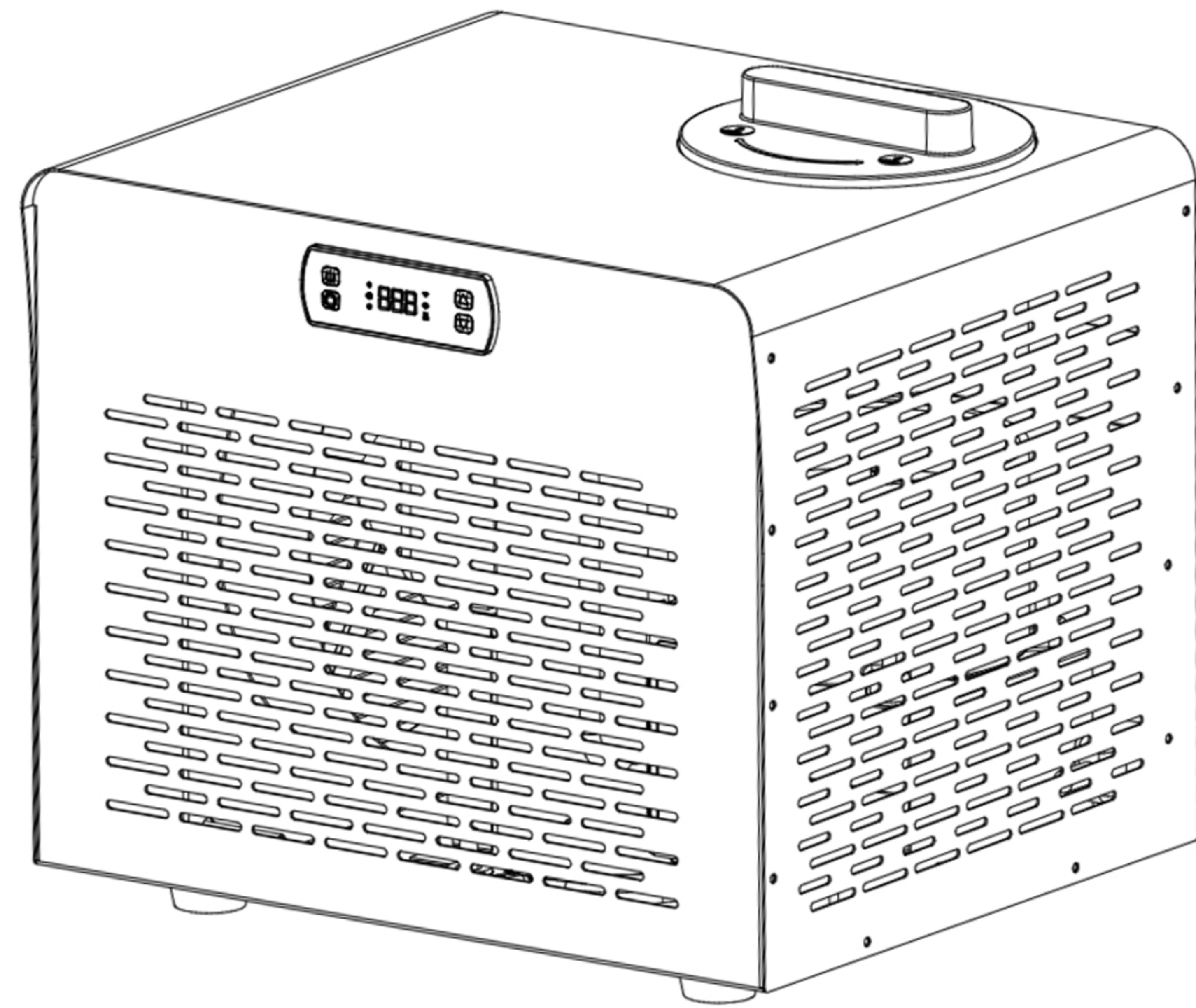

Preface

Thank you for choosing our chiller. We are honored that you trust our chiller. In order to let you fully understand our products and use them conveniently, we have specially prepared this user manual. Please read this manual for installation reference before use.

Features

1. High Efficiency and Energy Saving

The chiller adopts energy-saving cooling technology, which can provide stable and efficient cold water supply while reducing energy consumption.

2. Precise Control

Through the intelligent control system, users can set the temperature range and flow rate as needed, achieving precise temperature and flow control to meet the requirements of various scenarios.

3. Safety and Reliability

The chiller is equipped with multiple safety protection devices such as over-heating protection, over current protection, and leakage protection to ensure the safe and reliable operation of the equipment.

Warning

Do not cut off the power directly while the equipment is operating! Such improper operation may cause irreversible severe damage to core components such as the compressor and control system.

Correct shutdown procedure

Use the shutdown function on the equipment control panel or display to properly turn off the system. Only disconnect the external power after the system has completely stopped running.

Sterilization

The ozone sterilization cycle operates automatically:
20 minutes ON, followed by 60 minutes OFF. This cycle repeats continuously.

Specifications

Item	Model	Chiller 0.8Hp	
Cooling capacity	kW	2.050	
	10 ³ kcal/h	1.762	
Power voltage	V/Hz	100-120V/60Hz	200-240V/50Hz
Power supply	KW	0.790	
Rated current (cooling mode)	A	7	3.35
Compress or consumption	KW	0.740	
Water pump	KW	0.08	
Water head	m	6	
Water Flow rate	m ³ /h	1.00	
Connection	DN	25	
Noise	dB(A)	60	
Weight	Kg	30	
Dimension	Length(mm)	400	
	Width(mm)	340	
	Height(mm)	350	
Temperature range cooling time (From 20°C drop to 5°C for your reference)	50L	≤1.0H	
	100L	≤2.0H	
	200L	≤5.5H	

Above data based on testing in closed insulated ice barrel, 25°C room temperature

Operation

Pre-startup Operational Reminders:

Venting by Water Filling: First, fully open the inlet and outlet valves connecting the chiller and the bathtub. Maintain this for 3-5 minutes to ensure the internal pipes of the chiller are completely filled with water and any air has been purged.

Safety Check: Before operation, be sure to review "Safety Rules-B. Caution-8" and strictly adhere to the requirements regarding the minimum water level of the bathtub and the installation height of the chiller.

Startup Completion: Only after completing the above steps may the chiller be started.

WiFi Version:

1.LED Main Interface:



2.Controller Display Description:

- 1) "OFF" is displayed on the main interface when powered off.
- 2) The main interface displays the inlet water temperature when powered on.
- 3) The fault code is displayed when a malfunction occurs.

4) In cooling mode, the icon "❄️" is illuminated and flashes during defrosting.

5) In automatic mode, the icon "⌚" is illuminated.

6) Water pump activated: icon "🔄" illuminated; manual pump activation, icon flashes.

3.Button Definitions and Operations:

1) "🔌" key:

- ① Power button.
- ② On the main interface, briefly press this button to turn the power on or off.
- ③ On the parameter interface or parameter setting interface, press this button to return to the main interface.

2) "⚙️" key:

- ① Function key; when the unit is powered on, press and hold this button for 3 seconds to switch between heating/cooling/auto modes (not applicable for heating-only units).
- ② Short press "⚙️" can query the unit's status parameters, can be combined with the "⬆️" and "⬇️" keys to navigate through parameter pages for query.

3) "⬆️" and "⬇️" key:

- ① Up and Down scroll keys.
- ② On the main interface, these keys can be used to adjust the current set temperature.
- ③ Used in combination with the "⚙️" key to set parameters.
 - Press and hold the key "⬇️" for 3 seconds to enter Wi-Fi pairing mode.

4) Reset operation:

When powered off, Press and hold the key "  "for 3 seconds, can restore parameters to default values,"EFF" will be displayed upon successful operation.

Non-WIFI Version:

1.LED Main Interface:

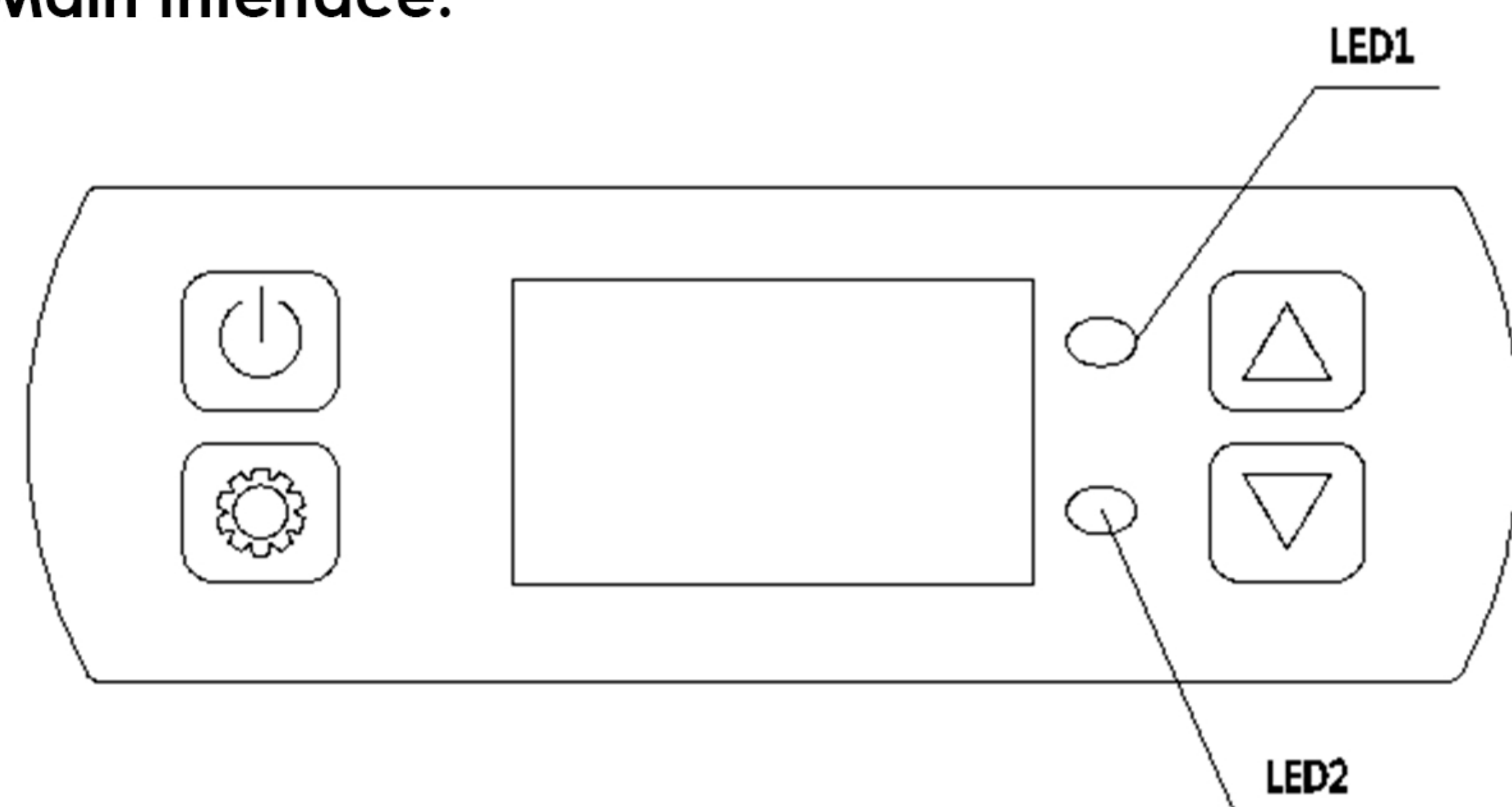

2.Controller Display Description:



- 1) "OFF" is displayed on the main interface when powered off.
- 2) The main interface displays the inlet water temperature when powered on.
- 3) The fault code is displayed when a malfunction occurs.
- 4) LED 1: The green LED 1 illuminates during cooling operation.
- 5) LED 2: The red LED 2 illuminates during heating operation (inactive for cooling-only units).

3.Button Definitions and Operations:

1) " " key:

- ① Power button.
- ② On the main interface, briefly press this button to turn the power on or off.



2) " " key:

- ① Function key: Press and hold this button for 3 seconds to switch between heating/cooling/auto modes (not applicable for cooling-only/ heating-only units).
- ② Short press"  "can query the unit's status parameters,can be combined with the"  " and "  "keys to navigate through parameter pages for query.

3) " " and " " key:

- ① Up and Down scroll keys.
- ② On the main interface, these keys can be used to adjust the current set temperature.
- ③ Used in combination with the"  "key to set parameters.

4) Reset operation:

When powered off, press and hold the "  " key + "  " key simultaneously for 5 seconds to restore parameters to default values.

5) Lock and Unlock Operation:

Press and hold the "  " key + "  " key simultaneously for 3 seconds to lock or unlock the keys.

List of error codes

Protection/Fault	Protection /Fault Code	Phenomenon
Ambient temperature too high or too low protection	E0	Please maintain smooth airflow inside the cooling engine
Inlet water temperature sensor malfunction	E1	Contact the manufacturer
Ambient temperature sensor malfunction	E2	Contact the manufacturer
Exhaust temperature too high protection	E3	Please maintain smooth airflow inside the cooling engine
Exhaust temperature sensor malfunction	E4	Contact the manufacturer
Coil sensor malfunction	E5	Contact the manufacturer
System low pressure fault	EL	Contact the manufacturer
System high pressure protection	EH	Contact the manufacturer
Water flow protection	E6	Please check if the water circuit is flowing properly

Attention



It is forbidden to add acidic, alkaline or other corrosive agents to the water, so as to prevent corrosion of the internal pipelines of the chiller and avoid equipment failures.



Note: Corrugated cardboard hoses are prohibited for use as connecting hoses between the chiller and the bathtub.



Note: The connecting hoses between the chiller and the bathtub must comply with the chiller's water specifications to ensure there are no leaks.

Maintenance Notes

- Power Down: Shut down the machine and turn off the power before performing any maintenance on the equipment.
- Avoid Direct Water Contact: Do not wash the unit directly with water.
- If any abnormalities are detected, turn off the power and seek guidance from the dealer. Continuing to use the unit in such conditions may result in electric shock or fire. Maintenance should only be performed by qualified personnel, and all power supplies must be disconnected before accessing electrical components.

Safety Rules

A. Warning:

1. This product is prohibited from being used in water or excessively humid environments, high temperatures, strong electromagnetic interference, and highly corrosive environments. The temperature sensor must not be immersed in organic solvent solutions.
2. This product must not be disassembled, displayed, or installed by non-professional personnel or without adequate static protection
3. Do not place the chiller outdoors.

B. Caution:

1. The supply voltage must match the voltage marked on the controller, and the supply voltage must be stable.
2. Biofilms or other biological materials can form inside the pipes and need to be cleaned with hot water to ensure proper sanitation. Regular maintenance per the manual's guidelines is essential to prevent such issues.
3. To avoid potential interference, it is recommended to keep the sensor and data lines at a proper distance from power lines.

4. Maintain a clearance of 50 centimeters between the chiller (front and back) and the wall or other objects, and a clearance of 20 centimeters on the sides, to ensure adequate air circulation during operation. Insufficient indoor air circulation can cause the surrounding temperature to rise, affecting cooling efficiency.
5. Do not cover the chiller while in use, and avoid shaking or impacting the machine.
6. Ensure that the chiller is placed on a stable and secure surface.
7. The cooling effect may vary due to installation location, surrounding heat sources, pipe length, pump, filter, and other connecting accessories. To achieve optimal performance, use the water pump and standard accessories provided with this chiller series.
8. The water level in the bathtub must be higher than the height of the water chiller.

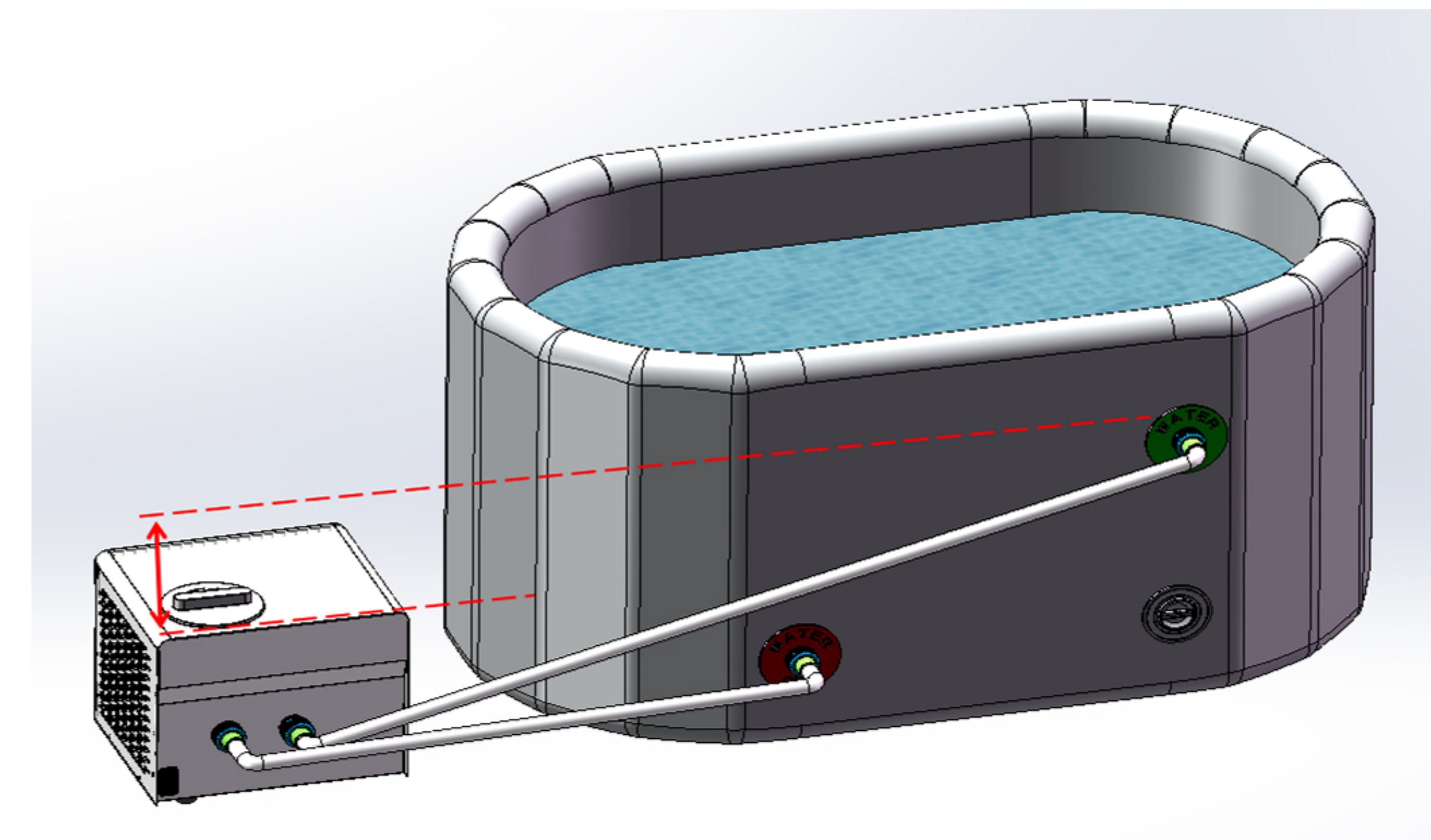

9. Do not use the chiller outdoors.

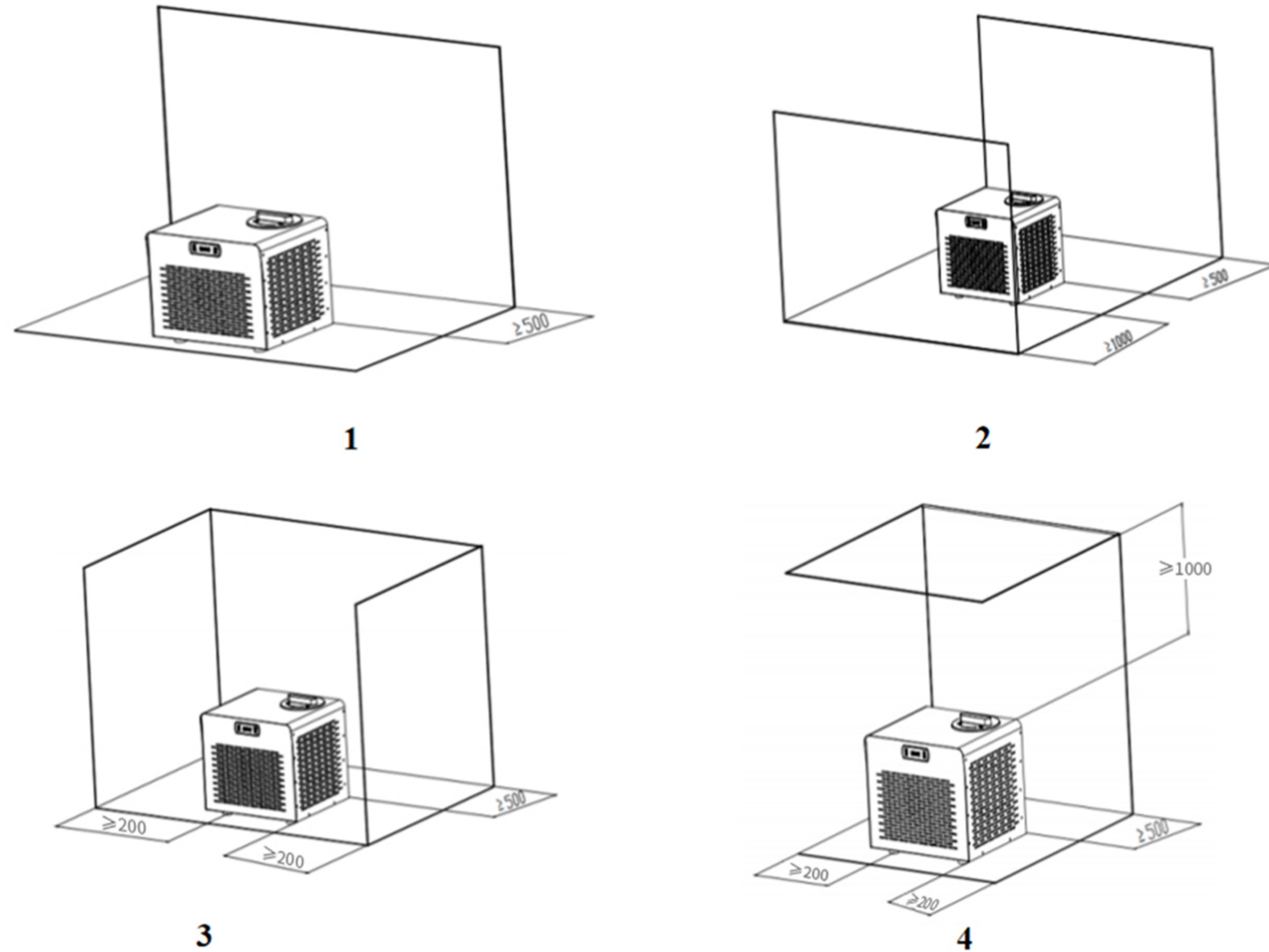

Figure 1: The distance between the air inlet side at the back of the main unit and obstacles shall be $\geq 500\text{mm}$.

Figure 2: The distance between the air outlet at the front of the main unit and obstacles shall be $\geq 1000\text{mm}$.

Figure 3: The distance between the left and right sides of the main unit and obstacles shall be $\geq 200\text{mm}$.

Figure 4: The distance between the top cover of the main unit and obstacles above shall be $\geq 1000\text{mm}$.

Add device through a mobile APP

Step 1: Download the mobile APP and complete the registration and login



Step 2:



Press and hold both keys for 3 seconds to enter Wi-Fi pairing mode.



The wifi icon began to flash

Step 3: Open the APP, add Device and match the chiller, the steps are as follows:

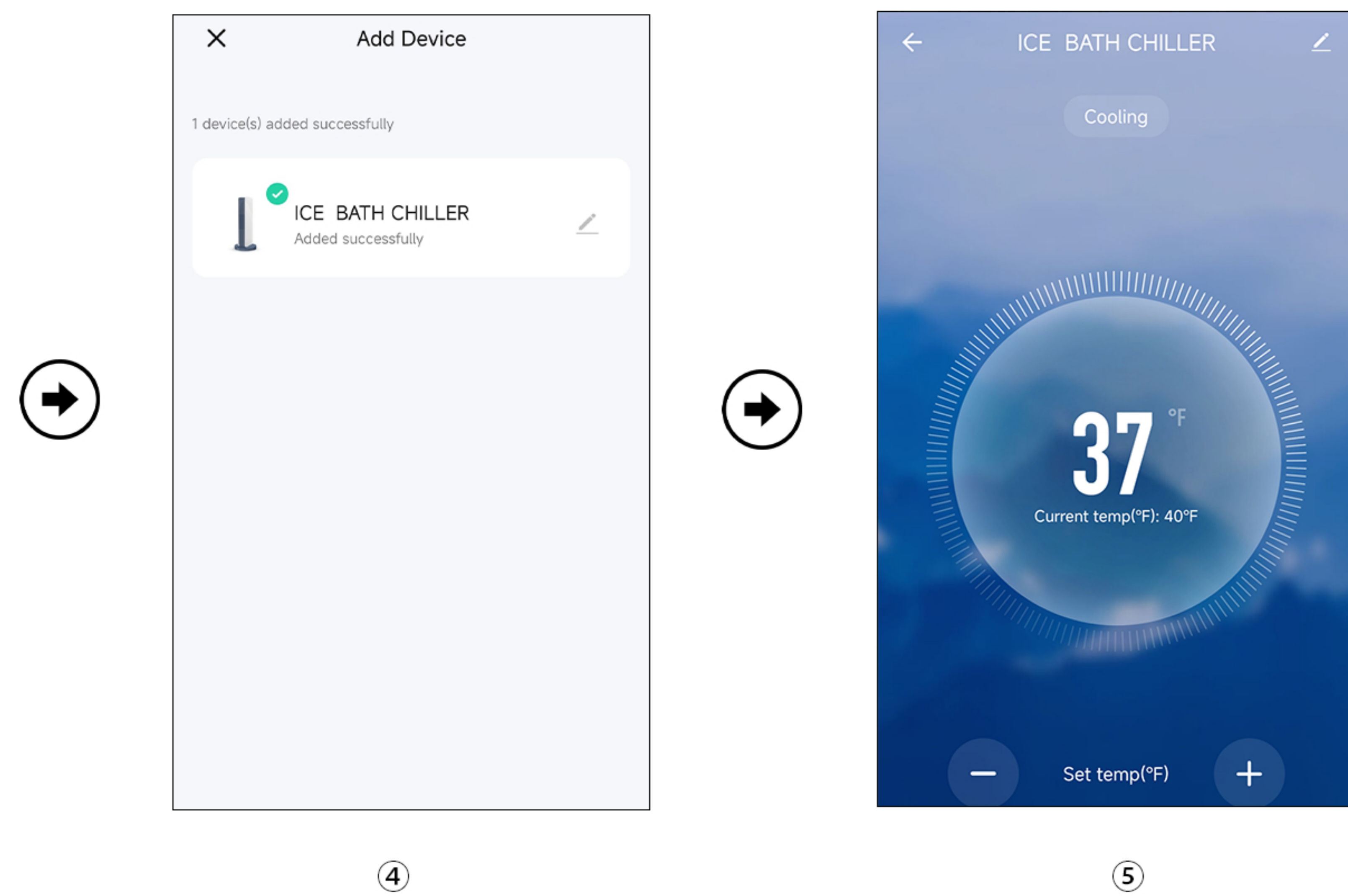
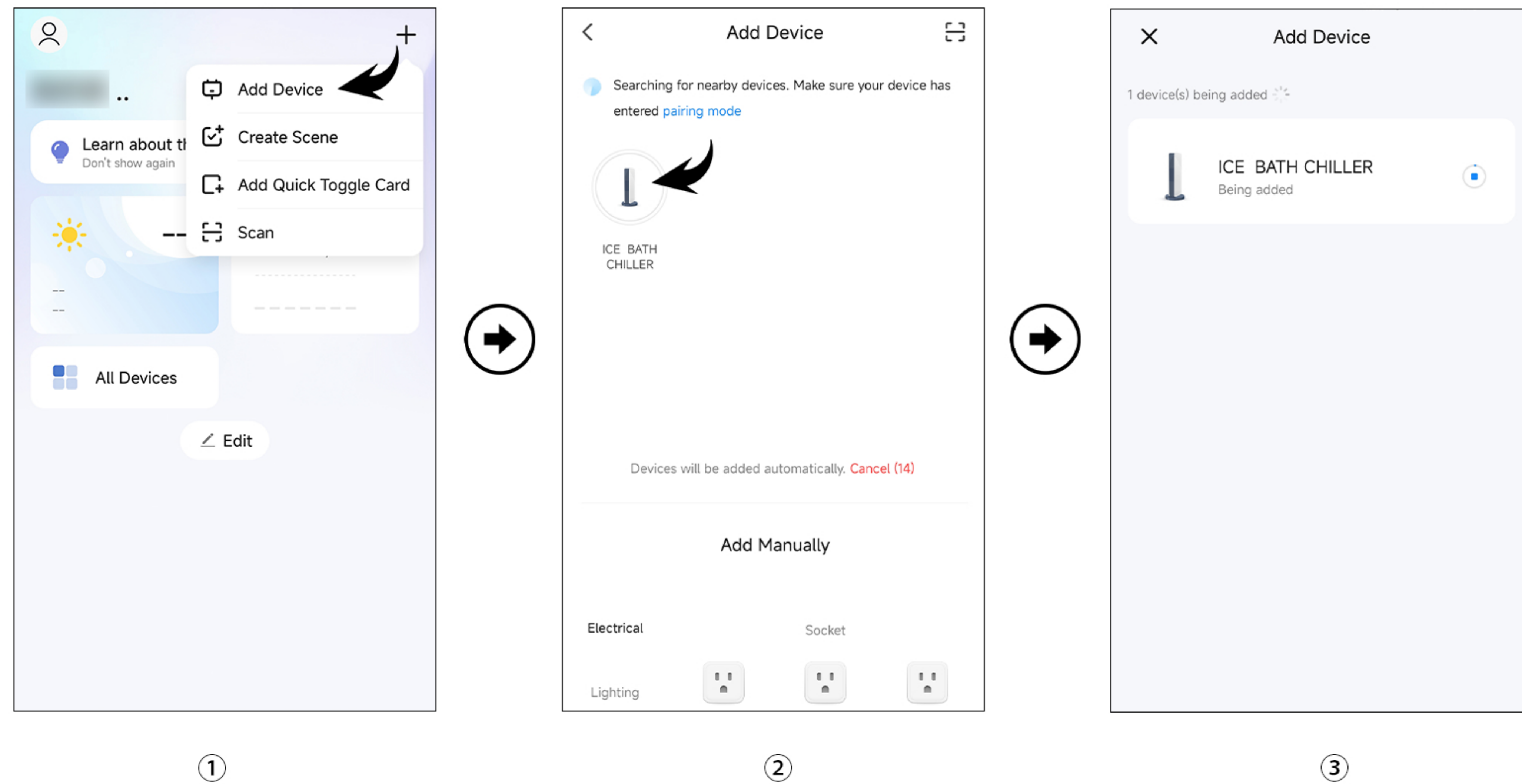

After-Sales and Technical Support

To ensure prompt assistance, please provide:

- Chiller code (e.g. 25MNWO.8P1017001)

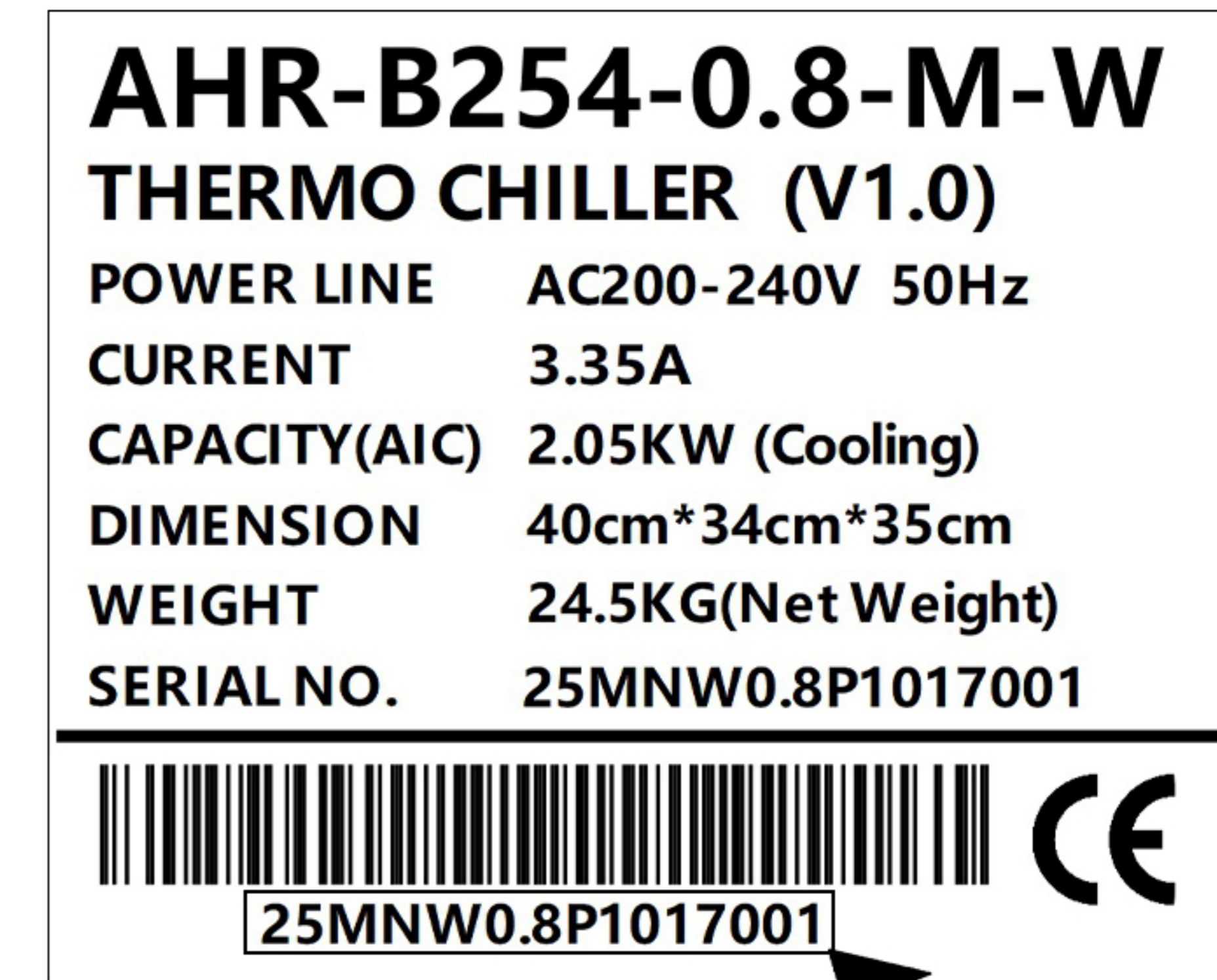

- Purchase date
- Fault description (with photos/videos recommended)