

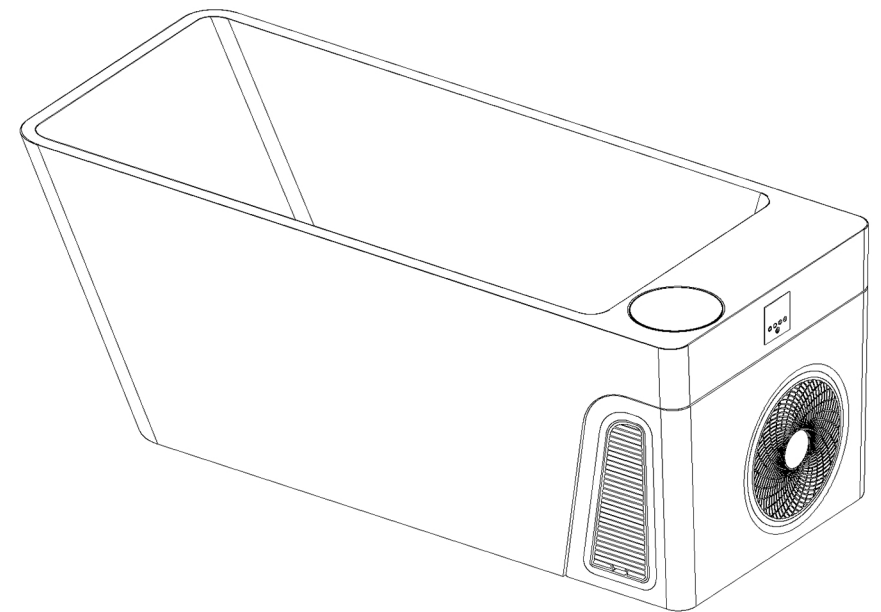

# Operating Instructions

**MODELO** *IB - ELITE*



SCAN ME!



VIDEO TUTORIAL

## Warnings

1. Protection for use: Do not use the chiller in environments that is too cold (below 7°C/45°F) or too hot (above 40°C/104°F) to avoid chiller failure or damage.
2. Frost protection: When the ambient temperature is lower than 2 °C/36°F, empty the water in the chiller. Otherwise, the cold water will freeze and crack.
3. Routine maintenance: It is recommended to clean the filter at least once a month.
4. Ventilation requirement: Especially for indoor use, attention should be paid to ventilation with the outdoors. Otherwise, the cooling efficiency may be reduced.
5. Hypothermia Warning: Prolonged exposure to cold water may result in hypothermia. If symptoms such as strong tremors, difficulty sleeping, speaking, weakened motor function, muscle stiffness, skin turning blue, or irregular heartbeat occur, stop use immediately and seek emergency medical assistance.
6. It is forbidden to add acidic, alkaline or other corrosive agents to the water, so as to prevent corrosion of the internal pipelines of the chiller and avoid equipment failures.
7. As our products undergo continuous iteration and upgrading, the content of this manual will be updated in real time in line with product optimizations. Relevant changes will be made without prior notice.

## Specification Parameters

Item		Model	IB-ELITEV-110V
Cooling capacity ①		kW	3.5
Heating capacity		kW	1
Power voltage		V/Hz	110-240V/60Hz
Power consumption ①		kW	1.19
MAX current ①		A	12
System MAX pressure ①		MPa	4.5
Temperature Setting Range ①		°C/°F	0~40°C / 32~104°F
Operating Ambient Temperature		°C/°F	3~40°C / 37~104°F
Water pump	Power	kW	0.15
	Flow rate	L/H	8000
	Water head	m	10
Air volume (@40Pa)		m³/h	1750
Noise (1 meter)		dB(A)	68
R32 charge amount		g	500
Dimension	Length	mm	1950
	Width	mm	800
	Height	mm	710
①Air temperature: 23°C/73°F ; Inlet water temperature: 15°C/59°F			

## Installation & Operation Diagram:

### 1. Open the package

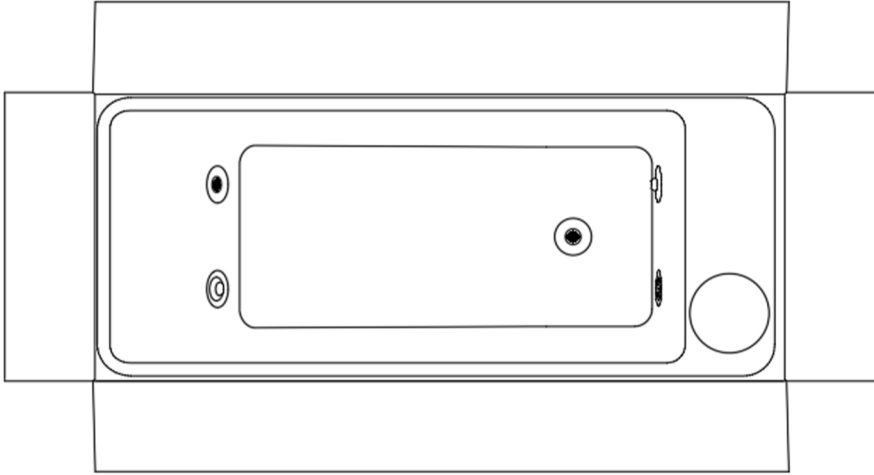

### 2. Take the Ice Bath unit out of the package (no inversion), place it on a stable and firm ground, and let it stand for 24 hours.

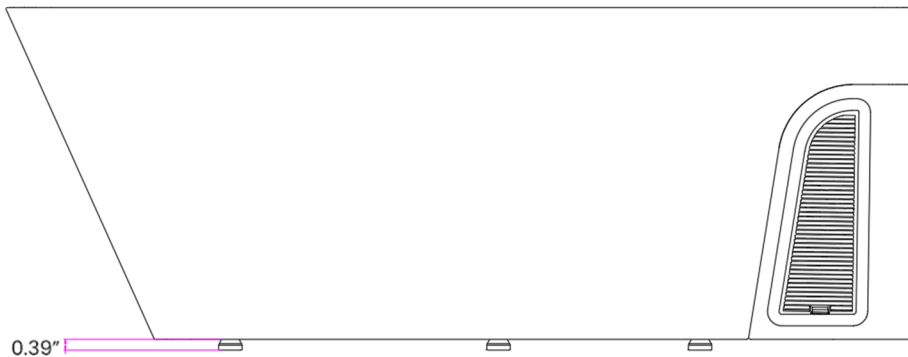

### 3. Installation location

- Avoid direct sunlight; ensure ventilation for heat exchange
- Air outlet (front) of the main unit must be  $\geq 39.37''$  from obstacles.
- Both left and right sides of the main unit must be  $\geq 7.87''$  from obstacles.

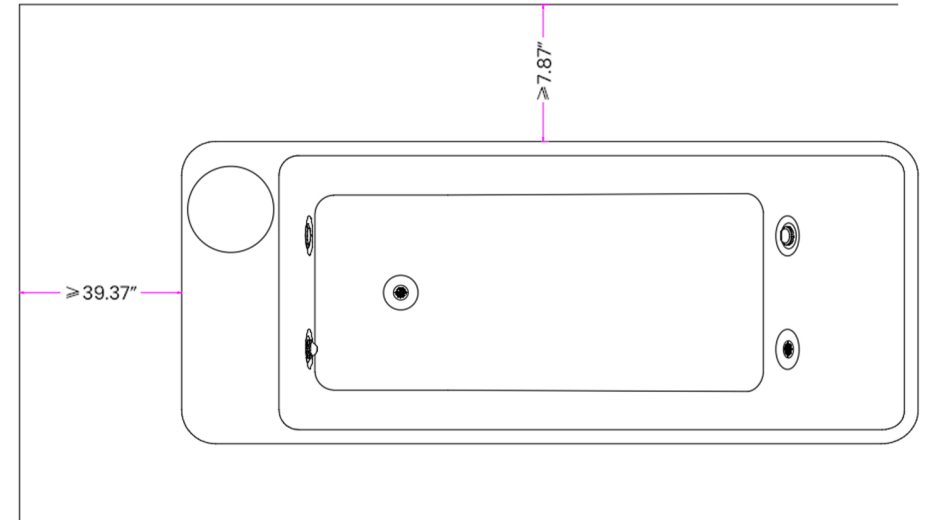

### 4. RV filter (flushing)

- Connect water pipe, rinse impurities, then fill bathtub

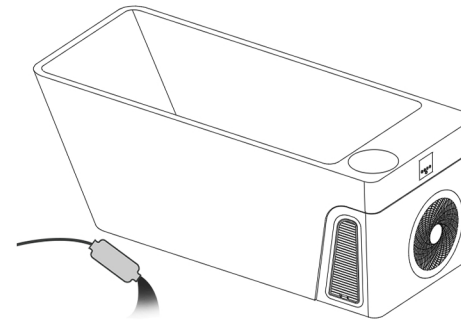

Img①

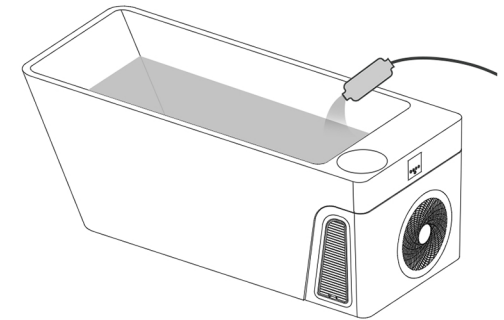

Img②

## 5. Power on

- Plug power cord into fixed socket (16A with ground, good grounding).
- Turn on leakage protection switch.

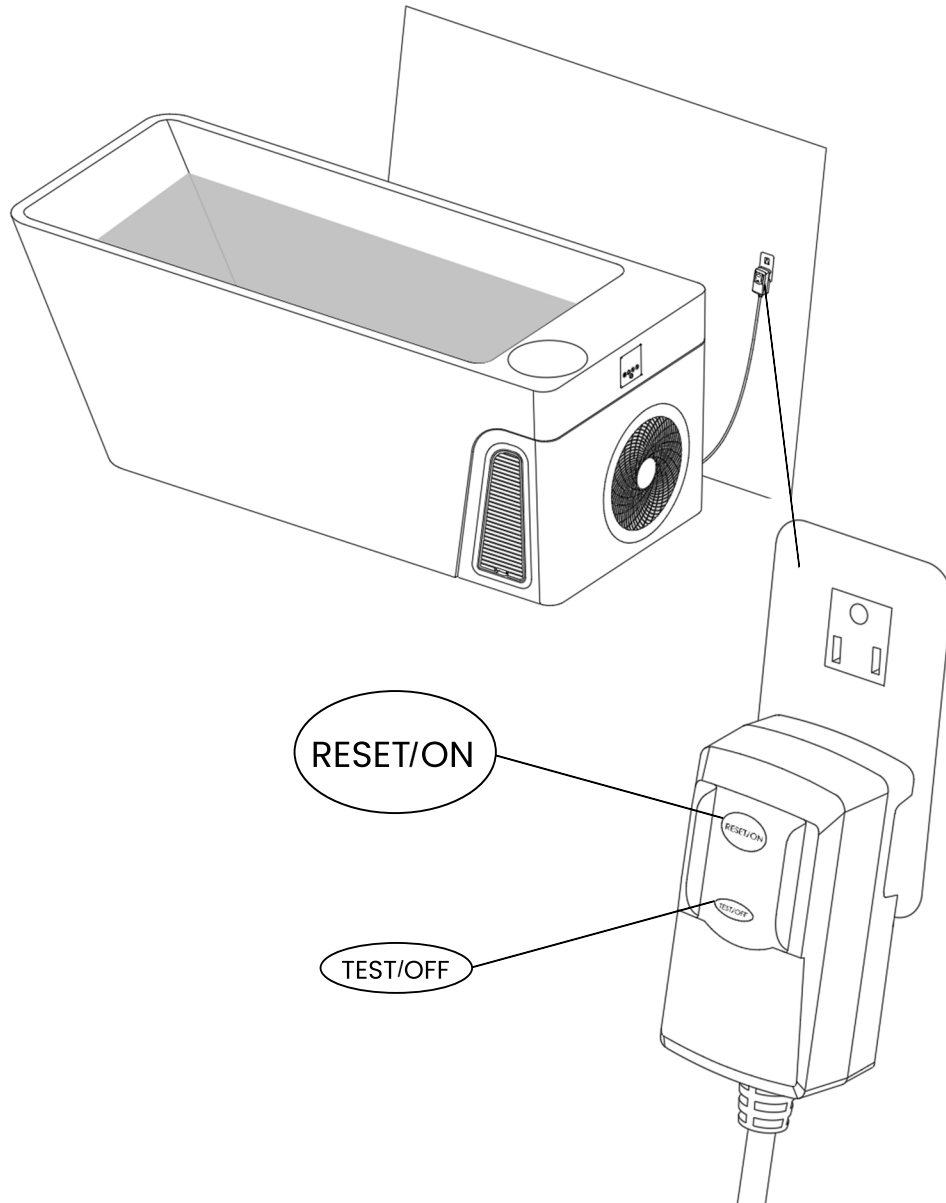

## 6. Control panel operation

### Automatic mode

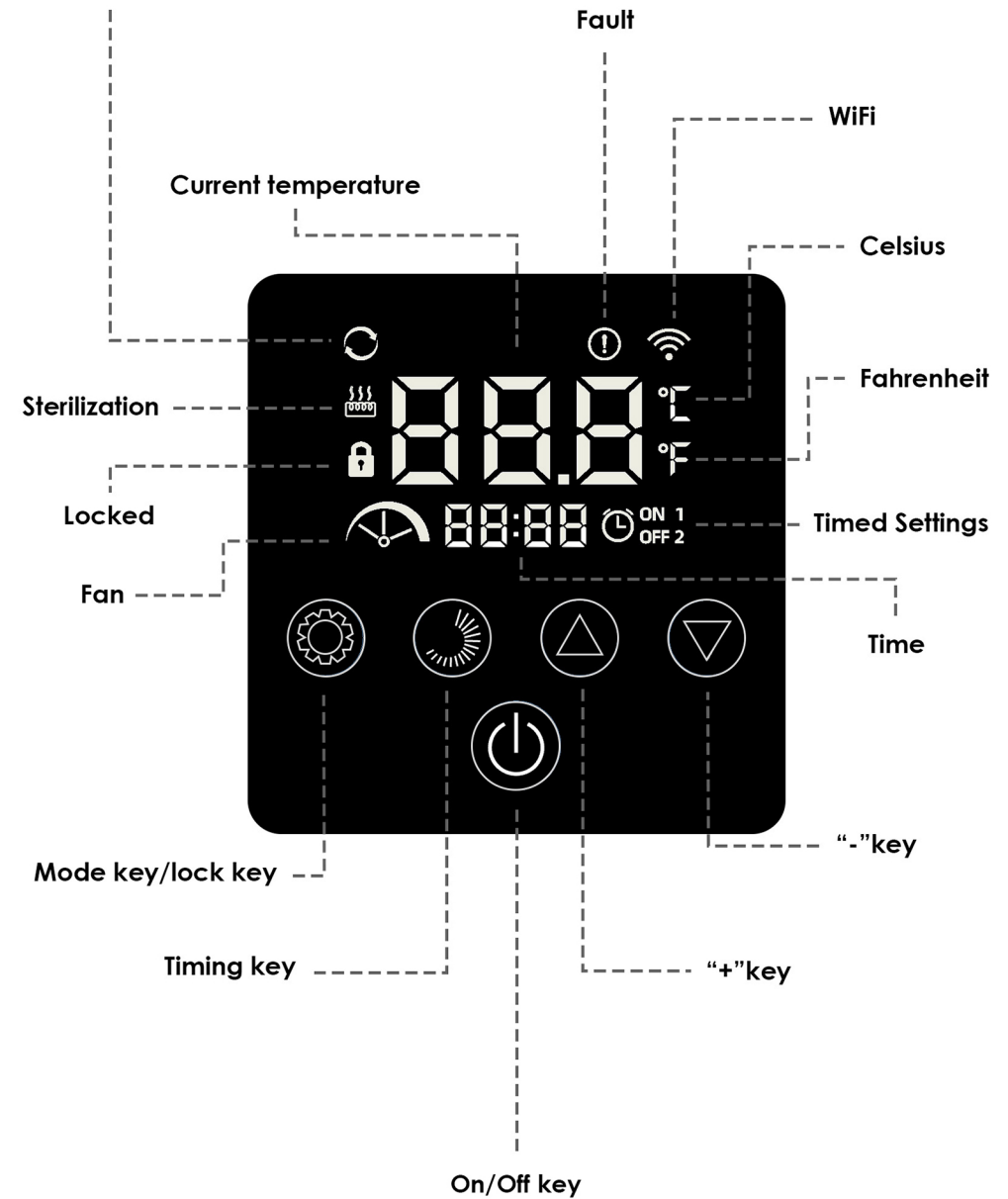



## Add device through a mobile APP

**Step 1:** Download the mobile APP and complete the registration and login



**Step 2:**



When unlocked, hold down the Settings key and the down key simultaneously for 3 seconds



The wifi icon began to flash

**Step 3:**



Turn on Bluetooth and wifi on your mobile phone

**Step 4:** Open the APP, add Device and match the chiller, the steps are as follows:

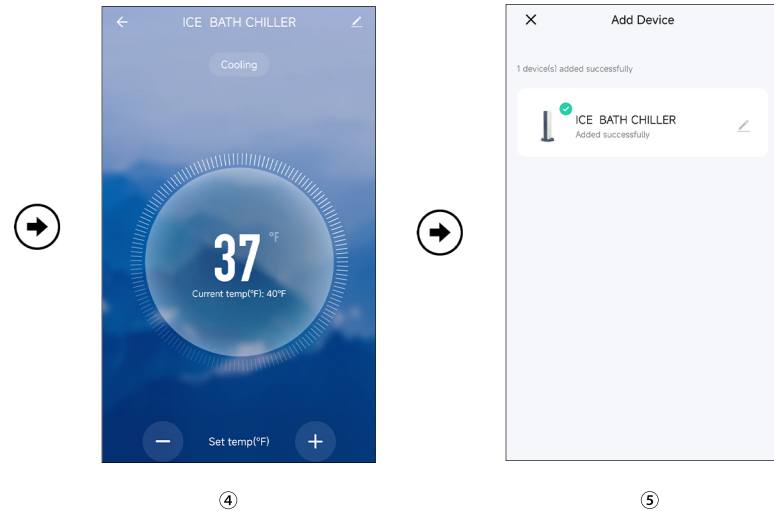
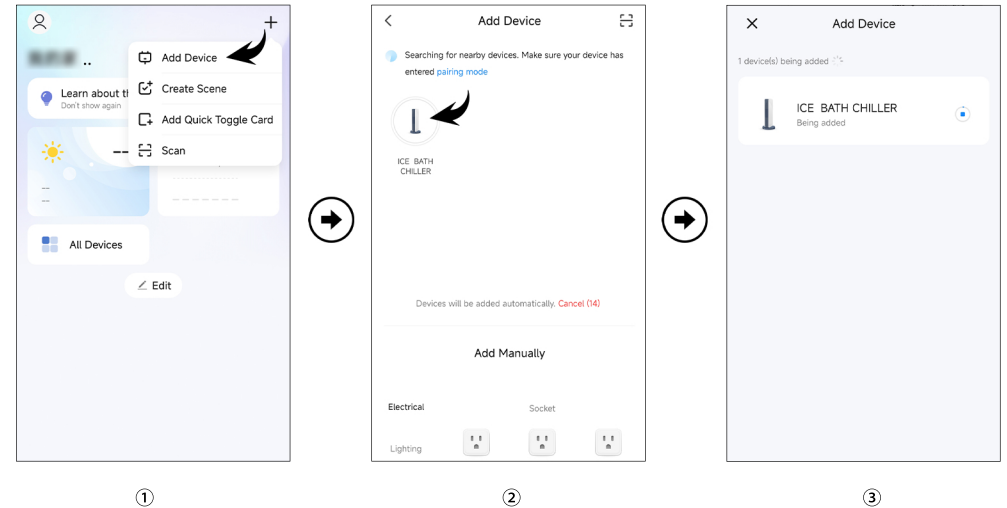

## 7. Cover with the insulation lid

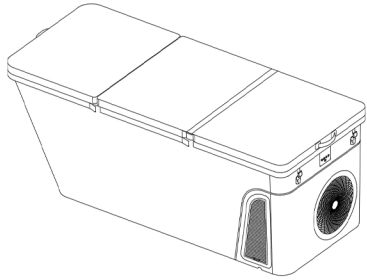

## 8. Replace pleated filter

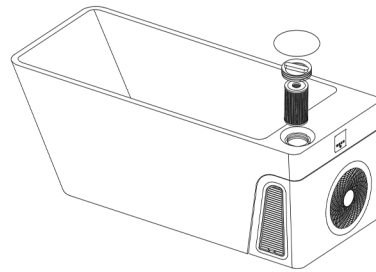

## 9. Bathtub stainless steel filter cleaning

It is recommended that part ③ be cleaned once a week, when cleaning, you can open ② with ① and take out ③ for cleaning.

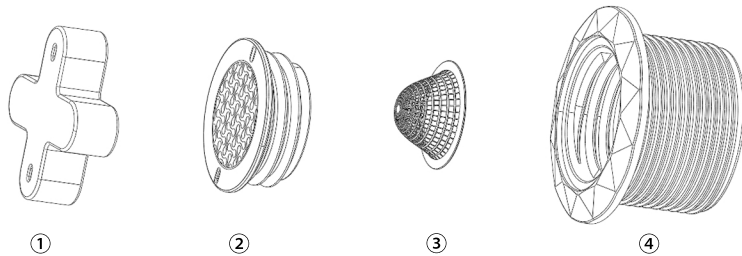

## 10. Drain

1) During normal use, please open drain port ① or ③ for drainage.  
2) When the ambient temperature is lower than 2°C/36°F, the ①②③

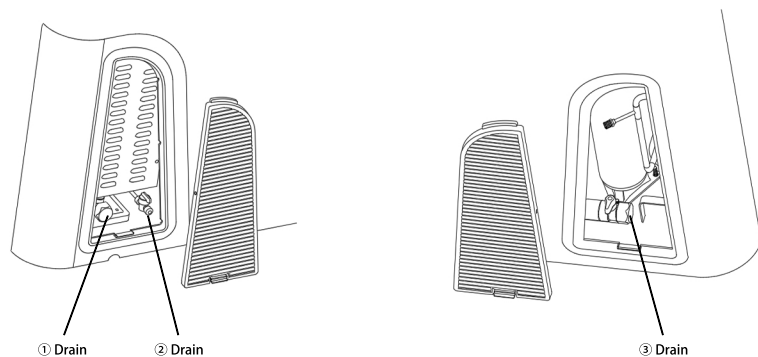

## List of error codes

Error code	Description	Solution	
E01	Exhaust temperature failure	Please contact the manufacturer	
E05	Fault of coil temperature		
E09	Return temperature failure		
E19	Water inlet temperature failure		
E18	Outflow temperature failure		
E13	Cooling coil temperature failure		
E21	Communication failure		
E22	Environmental temperature failure		
P01	Fault of flow switch		Please check whether the water circuit is operating normally
P09	Low suction gas temperature		Please contact the manufacturer
P11	Exhaust temperature protection	Please keep the air in the chiller open	
P15	Prevent the excessive temperature difference between the inlet and outlet water	Check the pump for working properly	
P25	Environmental temperature protection	Please keep the air in the chiller open	

## Extra note:

The ozone sterilization cycle operates automatically:  
20 minutes ON, followed by 60 minutes OFF. This cycle repeats continuously.

## After-Sales and Technical Support

To ensure prompt assistance, please provide:

- Chiller code(e.g.25YT1MW0523056)

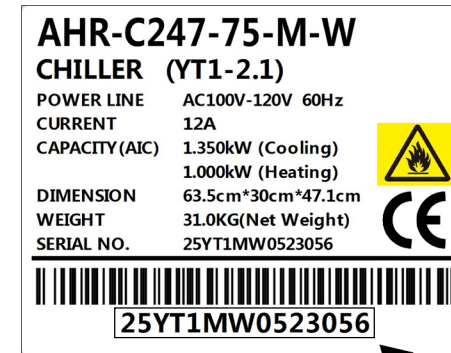

- Purchase date
- Fault description (with photos/videos recommended)